

# COAXIAL ADAPTERS

K, V, K to V DC to 65 GHz

The K230 Series is the panel-mount version of the K220 Series Adapters. These units mount in a standard 9.5 mm “D” hole.

## K and V panel adapter features

- Precision, panel-mounted feedthru adapter
- Broad, DC to 65 GHz frequency range

## K panel adapter specifications

Model	Frequency range (GHz)	Connectors	SWR
K230B	DC to 40	K(m) to K(m)	1.12
K232B		K(f) to K(f)	
K234B		K(f) to K(m)	

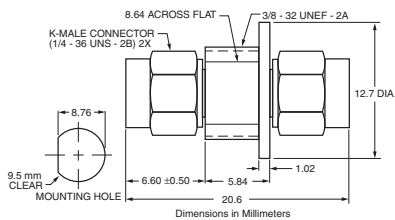

K230B outline

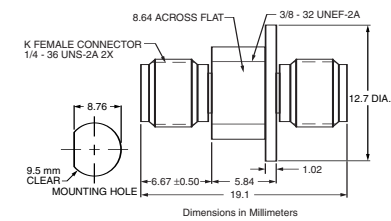

K232B outline

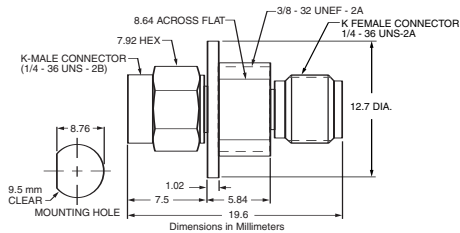

K234B outline

## V panel adapter specifications

Model	Frequency range (GHz)	Connectors	SWR
V230	DC to 65	V(m) to V(m)	1.5
V232		V(f) to V(f)	
V234		V(f) to V(m)	

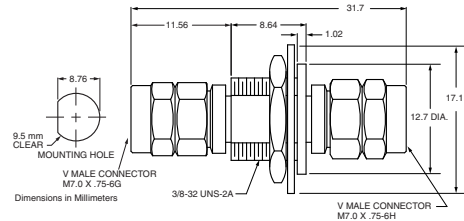

V230 outline

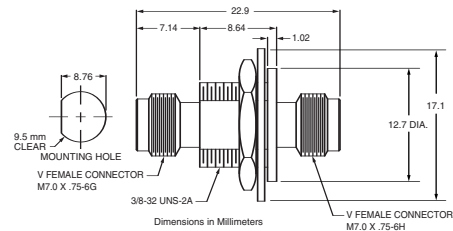

V232 outline

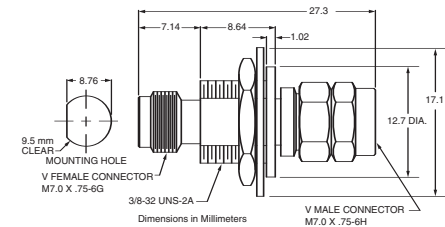

V234 outline

## Ordering information

Please specify model/order number, name and quantity when ordering.

Model/Order No.	Name
	<b>Precision adapter</b>
K220B	DC to 40 GHz, 50 Ω, K(m)-K(m)
K222B	DC to 40 GHz, 50 Ω, K(f)-K(f)
K224B	DC to 40 GHz, 50 Ω, K(m)-K(f)
K230B	DC to 40 GHz, 50 Ω, K(m)-K(m)
K232B	DC to 40 GHz, 50 Ω, K(f)-K(f)
K234B	DC to 40 GHz, 50 Ω, K(f)-K(m)
34VK50	DC to 46.5 GHz, 50 Ω, V(m)-K(m)
34VKF50	DC to 40 GHz, 50 Ω, V(m)-K(f)
34VFK50	DC to 40 GHz, 50 Ω, V(f)-K(m)
34VFKF50	DC to 40 GHz, 50 Ω, V(f)-K(f)
34VV50	DC to 65 GHz, 50 Ω, V(m)-V(m)
34VVF50	DC to 65 GHz, 50 Ω, V(m)-V(f)
34VVFV50	DC to 65 GHz, 50 Ω, V(f)-V(f)
V230	DC to 65 GHz, 50 Ω, V(m)-V(m)
V232	DC to 65 GHz, 50 Ω, V(f)-V(f)
V234	DC to 65 GHz, 50 Ω, V(f)-V(m)